



CONSTRUCTION NOTICE: May 8 - 12

I-215 / Holland Road Overpass



CONSTRUCTION ACTIVITIES - LOCATION	ACTIVITIES
1 Holland Rd between Antelope Rd and Hanover Ln	• Continue multiple utility relocations (by others).
2 Holland Rd between I-215 and Haun Rd	• Continue installing a drainage systems. • Continue importing dirt for the bridge and roadway.
3 Westside of Antelope Rd at Holland Rd	• Bridge: Continue to drill and install rebar cages for the bridge bent (3) columns.
4 Northbound/Southbound I-215 (Behind k-rail)	• Bridge: Continue to excavate and begin to drill for the bridge bent (2) columns.

ROADWAY CLOSURES AND RESTRICTIONS - LOCATION	CLOSED	OPEN	DATE
1 Holland Rd between Antelope Rd and Hanover Ln	• Holland Rd is fully CLOSED .	• No lanes will remain open.	• 24/7
5 Antelope Rd between Albion Ave and Aspenwood Way	• One lane in each direction is CLOSED .	• One lane in each will remain open.	• 24/7

FREEWAY LANE RESTRICTIONS	CLOSED	OPEN	DATES AND TIME
• Northbound/Southbound I-215 from Newport Rd to Scott Rd (alternate):	• Alternating freeway lanes. Up to two lanes will be closed in direction at a time.	• At least one lane in each direction will be open.	<ul style="list-style-type: none"> • Mon.-Thurs., May 8-11 <ul style="list-style-type: none"> ◦ Southbound I-215: 8 pm - 4 am ◦ Northbound I-215: 9 pm - 5 am • Fri., May 12 <ul style="list-style-type: none"> ◦ Northbound I-215: 9 pm - 6 am ◦ Southbound I-215: 11 pm - 6 am

WHAT TO EXPECT

- Pedestrian access:
 - CLOSED:** Holland Rd.
 - OPEN:** Antelope Rd and Hanover Ln.
- Motorists can expect traffic delays.
- Drive with caution throughout the project area and allow extra time to reach your destination.
- Water trucks will be used to maintain dust control during construction.
- Expect to see large equipment and construction noise.
- Schedule is subject to change based on weather, or unexpected events.

WORKING HOURS

- Daytime, Mon.-Fri., from 6:30 am to 4 pm
- Nighttime Freeway, Sun.-Thurs., between 8 pm to 5 am, Sat. between 9 pm - 6 am (as-needed)

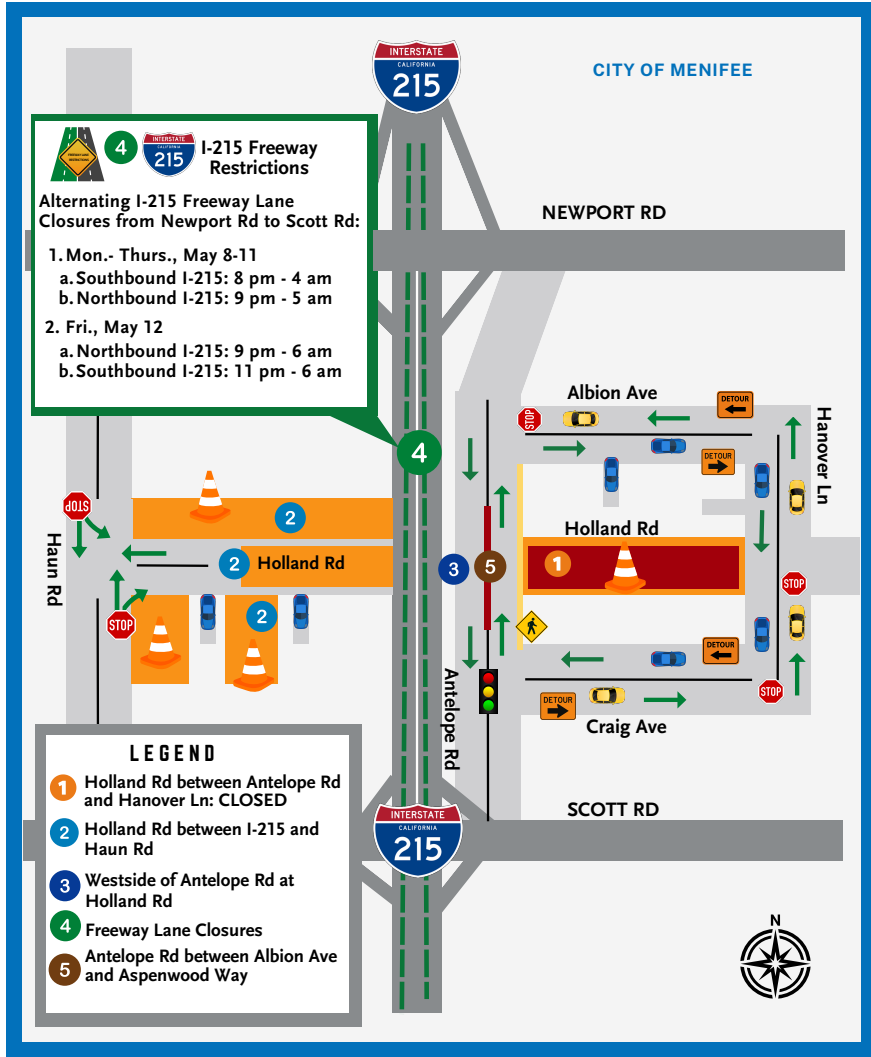

TEXT Updates: Text HOLLAND to 74121

EMAIL Updates: Text HOLLAND to 66866

(951) 200-4146

hollandoverpass.com

info@hollandoverpass.com

