

# CONSTRUCTION NOTICE: May 30 - June 2

## I-215 / Holland Road Overpass



In observance of Memorial Day, no work will be scheduled on Monday, May 29. Work will resume on Tuesday, May 30.

CONSTRUCTION ACTIVITIES -LOCATION	ACTIVITIES
1 Holland Rd between Antelope Rd and Hanover Ln	• Continue multiple utility relocations (by others).
2 Holland Rd between I-215 and Haun Rd	• Continue importing fill material for the bridge embankment and roadway.
3 Northbound/Southbound I-215 (Behind k-rail)	• Bridge: Continue to drill for the bridge bent (2) piles.

ROADWAY CLOSURES AND RESTRICTIONS - LOCATION	CLOSED	OPEN	DATE
1 Holland Rd between Antelope Rd and Hanover Ln	• Holland Rd is fully <b>CLOSED</b> .	• No lanes will remain open.	• 24/7

FREEWAY LANE RESTRICTIONS	CLOSED	OPEN	DATES AND TIME
4 Northbound/Southbound I-215 from Newport Rd to Scott Rd (alternating lanes):	• Alternating freeway lanes. Up to two lanes will be closed per direction at a time.	• At least one lane in each direction will be open.	<ul style="list-style-type: none"> <li>Tues.-Thurs., May 30-June 1                             <ul style="list-style-type: none"> <li>Southbound I-215: 8 pm - 4 am</li> <li>Northbound I-215: 9 pm - 5 am</li> </ul> </li> <li>Fri., June 2                             <ul style="list-style-type: none"> <li>Northbound I-215: 9 pm - 6 am</li> <li>Southbound I-215: 11 pm - 6 am</li> </ul> </li> </ul>

### WHAT TO EXPECT

- Pedestrian access:
  - CLOSED:** Holland Rd.
  - OPEN:** Antelope Rd and Hanover Ln.
- Motorists can expect traffic delays.
- Drive with caution throughout the project area and allow extra time to reach your destination.
- Water trucks will be used to maintain dust control during construction.
- Expect to see large equipment and construction noise.
- Schedule is subject to change based on weather, or unexpected events.

### WORKING HOURS

- Daytime, Mon.-Fri., from 6:30 am to 4 pm
- Nighttime Freeway, Sun.-Thurs., between 8 pm to 5 am, Sat. between 9 pm - 6 am (as-needed)

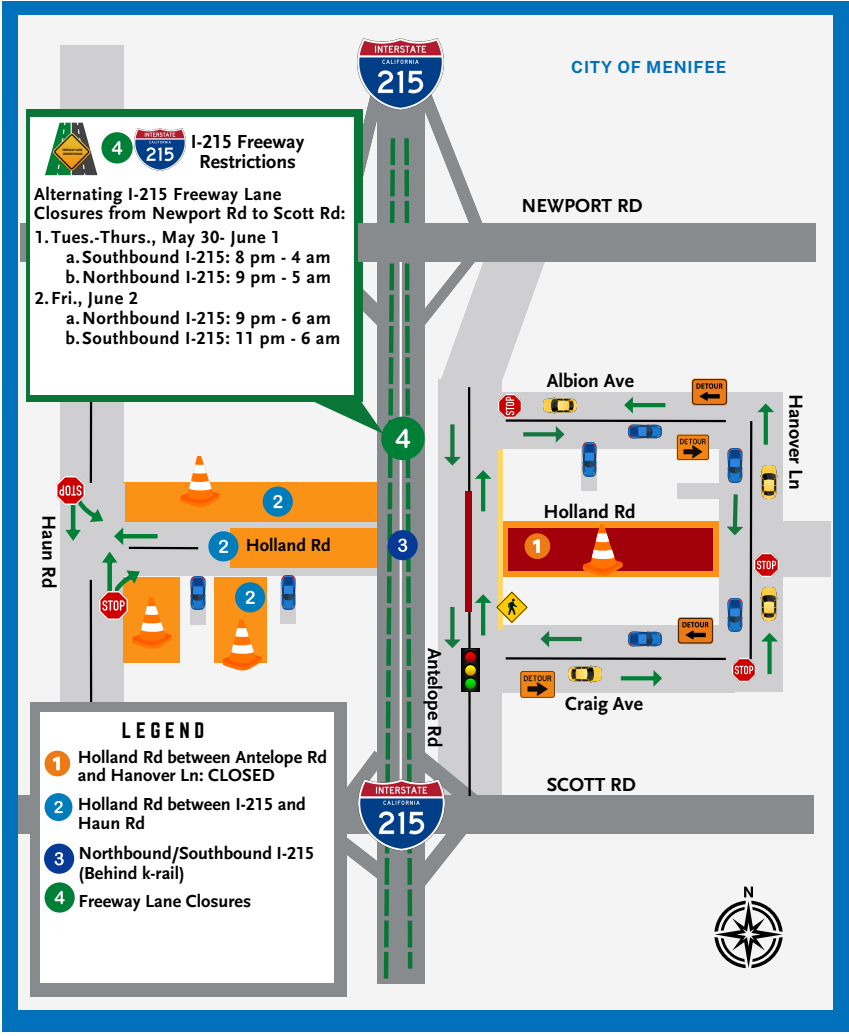

TEXT Updates: Text HOLLAND to 74121

EMAIL Updates: Text HOLLAND to 66866

(951) 200-4146

[hollandoverpass.com](http://hollandoverpass.com)

[info@hollandoverpass.com](mailto:info@hollandoverpass.com)



SCAN ME