



CONSTRUCTION NOTICE/CLOSURE: February 27 - March 3

I-215 / Holland Road Overpass

CONSTRUCTION ACTIVITIES

LOCATION	ACTIVITIES
1 Holland Rd between Antelope Rd and Hanover Ln	<ul style="list-style-type: none"> Continue clearing and grubbing. Continue excavate for the bridge abutment. Remove roadway asphalt.
2 Holland Rd at Haun Rd	<ul style="list-style-type: none"> Continue installing a sewer line.
3 Holland Rd between I-215 and Haun Rd	<ul style="list-style-type: none"> Excavate and back-fill the Paloma wash.

ROADWAY CLOSURES AND RESTRICTIONS

LOCATION	CLOSED	OPEN	DATE
1 Holland Rd between Antelope Rd and Hanover Ln	<ul style="list-style-type: none"> Holland Rd is fully CLOSED. 	<ul style="list-style-type: none"> No lanes will remain open. 	<ul style="list-style-type: none"> 24/7
1 Antelope Rd between Albion Ave and Aspenwood Way	<ul style="list-style-type: none"> One lane in each direction is CLOSED. 	<ul style="list-style-type: none"> One lane in each direction will remain open. 	<ul style="list-style-type: none"> 24/7
2 Holland Rd at Haun Rd	<ul style="list-style-type: none"> Haun Rd merging lanes Holland Rd middle lane. 	<ul style="list-style-type: none"> One lane in each direction will remain open. 	<ul style="list-style-type: none"> Feb. 14- April 2023 24/7

WHAT TO EXPECT

- 4 Pedestrian access:
 - CLOSED:** Holland Rd.
 - OPEN:** Antelope Rd and Hanover Ln.
- Motorists can expect traffic delays.
 - Drive with caution throughout the project area and allow extra time to reach your destination.
- Water trucks will be used to maintain dust control during construction.
- Expect to see large equipment and construction noise.
- Schedule is subject to change based on weather, or unexpected events.

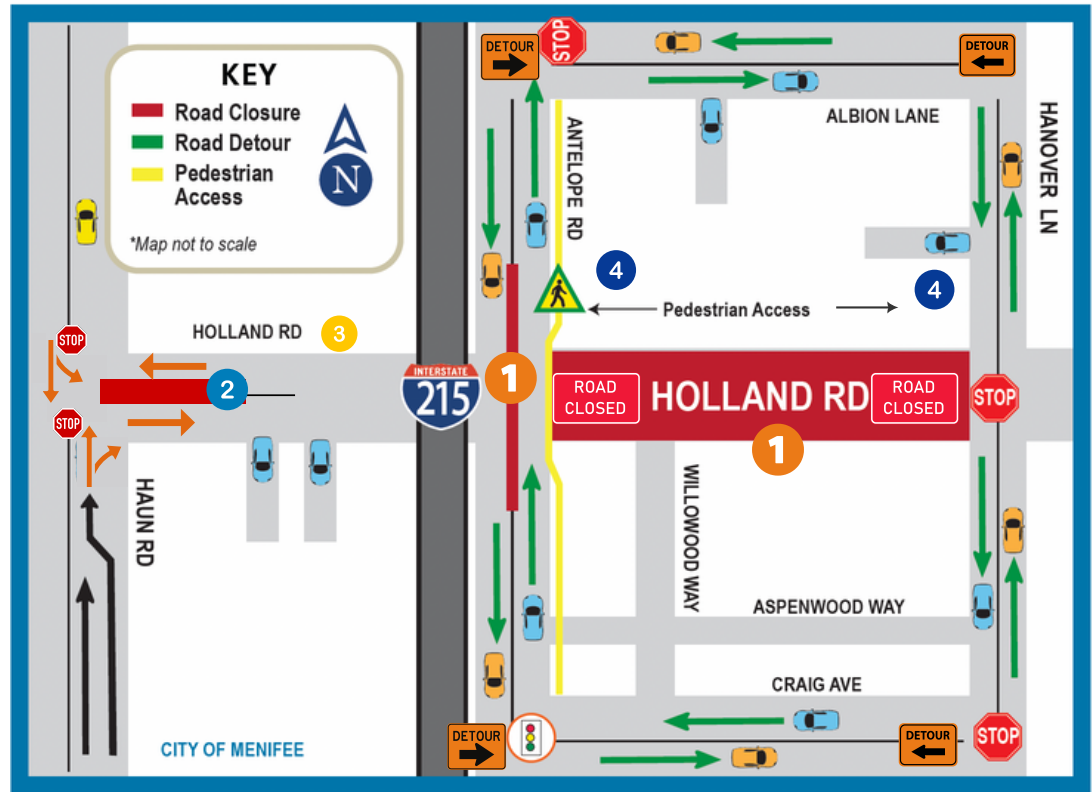

SIGN UP!

(951) 200-4146 | info@hollandoverpass.com | hollandoverpass.com

TEXT Updates: Text HOLLAND to 74121 or EMAIL Updates: Text HOLLAND to 22828

SCAN ME

