

# CONSTRUCTION NOTICE: October 16-20

## I-215 / Holland Road Overpass



LOCATION	CONSTRUCTION ACTIVITIES
1 Holland Rd between Antelope Rd and Hanover Ln	<ul style="list-style-type: none"> <li>Continue multiple utility relocations (by others)</li> </ul>
2 Holland Rd between I-215 and Haun Rd	<ul style="list-style-type: none"> <li>Continue grading operation for bridge embankment and roadway.</li> <li>Continue utility relocations (by others).</li> </ul>
3 Between the Northbound/Southbound I-215	<ul style="list-style-type: none"> <li>Continue to construct bent (2) in the median.</li> </ul>

ROADWAY CLOSURES	CLOSED	OPEN
1 Holland Rd between Antelope Rd and Hanover Ln	<ul style="list-style-type: none"> <li>Holland Rd is <b>CLOSED</b>.</li> </ul>	<ul style="list-style-type: none"> <li>No lanes are open.</li> </ul>

ALTERNATING I-215 FREEWAY CLOSURES AND LANE RESTRICTIONS		
3 Monday -Thursday, October 16-19	<ul style="list-style-type: none"> <li>Southbound I-215 from 8 pm - 4 am</li> <li>Northbound I-215 from 9 pm - 5 am</li> </ul>	<ul style="list-style-type: none"> <li>Alternating freeway lanes. Up to two lanes will be closed per direction at a time.</li> <li>At least one lane will remain open.</li> </ul>
3 Friday, October 20	<ul style="list-style-type: none"> <li>Northbound I-215 from 9 pm - 6 am</li> <li>Southbound I-215 from 11 pm - 6 am</li> </ul>	<ul style="list-style-type: none"> <li>Alternating freeway lanes. Up to two lanes will be closed per direction at a time.</li> <li>At least one lane will remain open.</li> </ul>

### WHAT TO EXPECT

- Pedestrian access:
  - CLOSED:** Holland Rd.
  - OPEN:** Antelope Rd and Hanover Ln.
- Motorists can expect traffic delays.
- Water trucks will be used to maintain dust control during construction.
- Expect to see large equipment and construction noise.
- Schedule is subject to change based on weather, or unexpected events.

### WORKING HOURS

- Daytime, Mon.-Fri., from 6 am to 4 pm
- Freeway closures are subject to cancellation without notice.

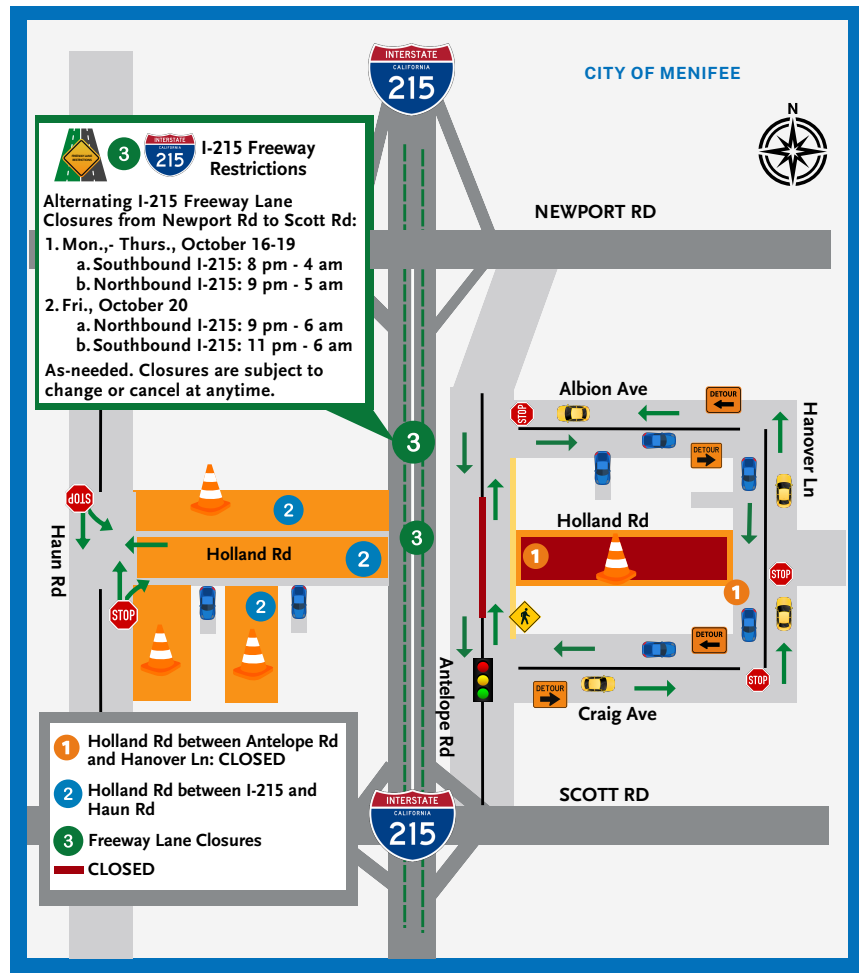

(951) 200-4146  
[hollandoverpass.com](http://hollandoverpass.com)  
[info@hollandoverpass.com](mailto:info@hollandoverpass.com)

TEXT Updates: Text HOLLAND to 74121  
 EMAIL Updates: Text HOLLAND to 66866