



I-215 / Holland Road Overpass

CONSTRUCTION ACTIVITIES

LOCATION	ACTIVITIES
1 Holland Rd at Haun Rd	<ul style="list-style-type: none"> Continue to relocate underground utilities.
2 Holland Rd between Antelope Rd and Hanover Ln	<ul style="list-style-type: none"> Continue to prepare to cut/cap irrigation, remove vegetation and landscaping.

ROADWAY RESTRICTIONS

LOCATION	CLOSED	OPEN	TIME/HOURS
1 Holland Rd at Haun Rd	<ul style="list-style-type: none"> Haun Rd merging lanes (as-needed). Holland Rd middle lanes (as-needed). 	<ul style="list-style-type: none"> At least one lane in each direction will remain open at all times. 	<ul style="list-style-type: none"> Ongoing - February 24 6:30am-4pm
2 Upcoming Closure: Holland Rd between Antelope Rd and Hanover Ln	<ul style="list-style-type: none"> UPCOMING Closure: Holland Rd will be fully CLOSED. A separate notice will include closure details, a detour map and will be hand delivered to the adjacent residents before the closure starts. 		<ul style="list-style-type: none"> The closure date will be confirmed.

WHAT TO EXPECT DURING CONSTRUCTION

- Traffic control devices/signage will be placed to direct traffic around the closure.
- Water trucks will be used to maintain dust control during construction.
- Expect to see large equipment entering/exiting the work area and construction noise.
- Drive with caution throughout the project area and allow extra time to reach your destination.
- The schedule is subject to change based on weather, or unexpected events.

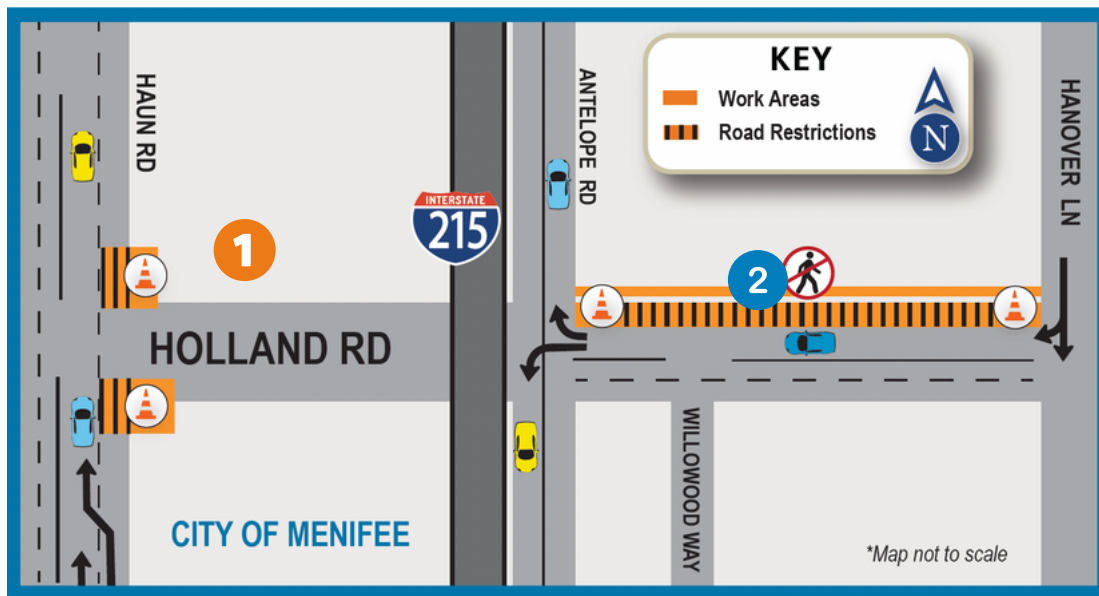

SIGN UP! (951) 200-4146 | info@hollandoverpass.com | hollandoverpass.com

TEXT Updates: Text HOLLAND to 74121 or EMAIL Updates: Text HOLLAND to 22828

