



I-215 / Holland Road Overpass

CONSTRUCTION ACTIVITIES

LOCATION	ACTIVITIES
1 Holland Rd at Antelope Rd	• Pothole, remove vegetation and landscaping.
2 Holland Rd at Haun Rd	• Relocate a manhole and prepare for other utilities.

ROADWAY RESTRICTIONS

LOCATION	CLOSURES	TIME/HOURS
• Holland Rd between Antelope Rd and Hanover Ln	• Closed: One lane and dedicated right-turn lane. • Open: One lane, dedicated right-turn lane and one dedicated left-turn lane.	• January 16-20 6:30am-4pm
• Holland Rd at Haun Rd	• Closed: Haun Rd merging lanes. • Open: One in each direction. Open trenches will be plated but may need to remain closed.	• January 16- February 24 6:30am-4pm

WHAT TO EXPECT DURING CONSTRUCTION

- Motorists can expect traffic delays during the closures.
- Traffic control devices/signage will be placed to direct traffic around the closures.
- Water trucks will be used to maintain dust control during construction.
- Expect to see large equipment and construction noise.
- Drive with caution throughout the project area and allow extra time to reach your destination.
- The schedule is subject to change based on weather, or unexpected events.
- **Utility Relocation by Others: SoCal Gas current work is on the eastside of the I-215. All work is being constructed and managed by SoCal Gas. For questions call General inquiries: 1-877-238-0092.**

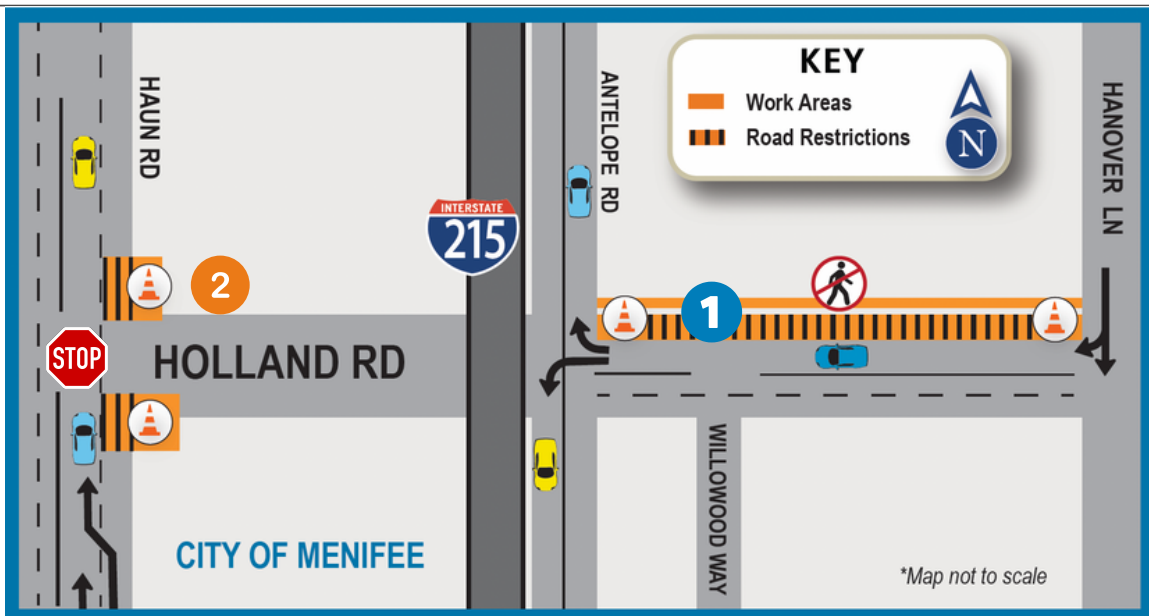

SIGN UP! (951) 200-4146 | info@hollandoverpass.com | hollandoverpass.com

TEXT Updates: Text HOLLAND to 74121 or EMAIL Updates: Text HOLLAND to 22828

