



I-215 / Holland Road Overpass



ROAD CLOSURE & LANE RESTRICTIONS

Thursday and Friday, January 16 and 17, 2025

Daily from 7 am to 5 pm

1 Major Work on Hanover Ln at Holland Rd Intersection

The contractor will grind and pave the intersection.

2 Road Closure on Albion Ave at Antelope Rd

- Local access ONLY. Apartment residents will be allowed to access Albion Rd.
- Flaggers will be onsite to direct traffic. **The road will reopen daily at 5 pm.**
- **Detour:** Use Antelope Rd to Craig Ave to Hanover Ln. Use Holland Rd (from Haun Rd) to Hanover Ln. Use Albion Ave to Hanover Ln to Holland Rd.

3 Lane Closures on Hanover Ln and/or Holland Rd

- **CLOSED:** One full directional lane will be closed at a time. Traffic will be switched from one side to the other on Hanover Ln or Holland Rd.
- **OPEN:** At least one or two lanes will remain open at all times. Flaggers will be onsite to direct traffic. **The lane restrictions will reopen throughout the day.**

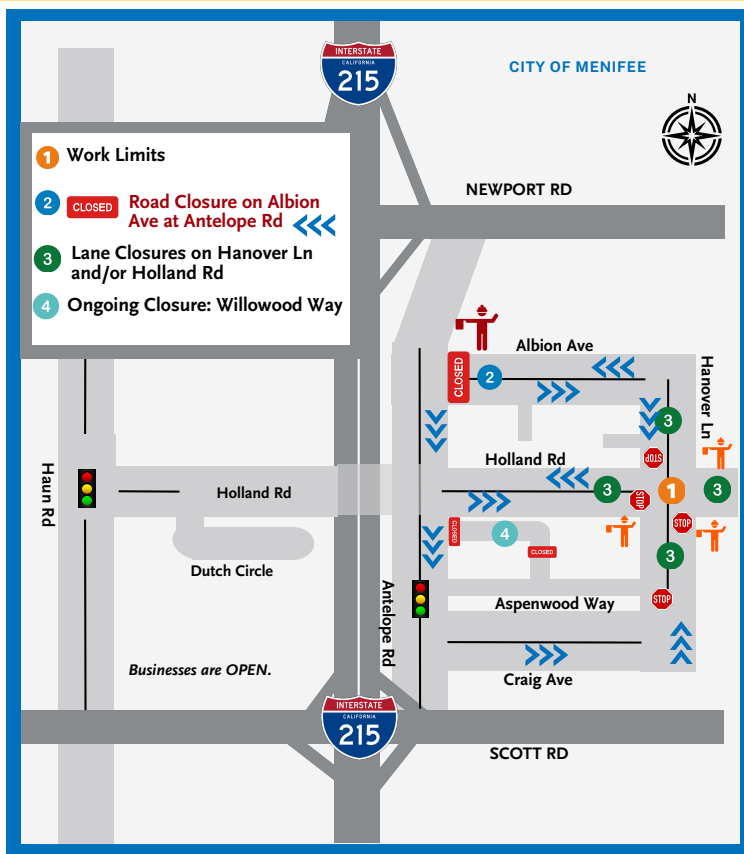

(951) 200-4146

hollandoverpass.com
info@hollandoverpass.com

WORKING HOURS

- Daytime, Mon.-Fri., from 7 am to 5 pm
- Freeway closures are subject to cancellation without notice.